

# Camping Pradelongue – Rental contract for a Mobile Home

+33 5 61 79 86 44 - [www.camping-pradelongue.com](http://www.camping-pradelongue.com) - [contact@camping-padelongue.com](mailto:contact@camping-padelongue.com)  
SAS with a capital of 60 000 € - SIRET 335 002 127 00017 – MOUSTAJON 31110 LUCHON



Surname: .....

First name: .....

Address: .....

Number of people: ..... Dog (first and second categories are not allowed): ...

Children's age: ..... .....

Mobile-home selected: Coco Sweet 16m<sup>2</sup> – Bora 18m<sup>2</sup> - Ophéa 26m<sup>2</sup> - Declik 29m<sup>2</sup> - Taos F4 35 m<sup>2</sup> - Taos F6 40 m<sup>2</sup>

From ..... / ..... / ..... to ..... / ..... / ..... (Arrival until 4 pm, departure before 10 am)

## Deposit:

- Account of 30 % of the total rent: ..... (1)
- Reservation fee (fix): 25 € (2)
- Insurance in case of cancellation (optional): 2.90 % of the stay: ..... (3)

Total (1) + (2) + (3) = .....

## The balance of the rental price must be paid one month before your stay.

This document, issued in two copies, shall have the value of a **contract**. When signing, the customer agrees to pay the full rental price corresponding to the booking dates he or she indicates. All rentals are nominative and can under no circumstances be transferred or sublet.

**Modification and cancellation of stay:** see our general sales conditions which are an integral part of this contract.

**Cancellation and interruption of stay insurance:** You can take out cancellation insurance at the rate of 2.9% of the amount of the stay with the following guarantees:

- Cancellation of stay
- Interruption of stay
- Late arrival
- Vehicle replacement
- Forgetting a personal object in the rental

**Security deposit:** A security deposit of €200.00 will be required upon arrival (150,00€ for Coco Sweet), it will be fully refunded if no damage is found during the check-out inventory, and if the cleaning has been completed.

**NB:** The customer must be in possession of up-to-date civil liability insurance and must comply with the campsite rules.

Disputes concerning this contract will be submitted to the mediation of CM2C14 rue Saint Jean 75017 PARIS

Date : ..... / ..... / .....

Tenant signature :

Date : ..... / ..... / .....

Manager signature :

MH :

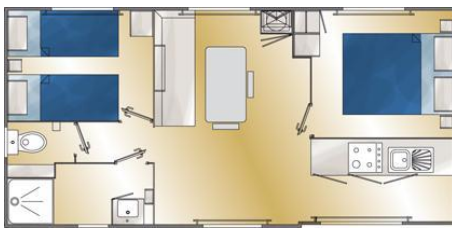

MH DECLIK 29m<sup>2</sup> - 2017, 2018 and 2020  
5 persons - 2 bedrooms- 1 bathroom  
1 toilet – terrace 15 m<sup>2</sup>

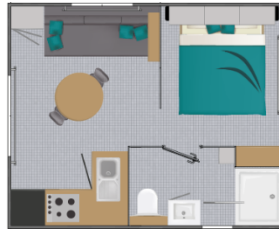

MH BORA 18 m<sup>2</sup> - 2022  
2 persons- 1 open bedroom  
1 bathroom with toilet - terrace 11m<sup>2</sup>



MH TAOS F4 35m<sup>2</sup> - 2021  
4 persons 2 bedrooms- 2 bathrooms  
2 toilets – terrace 19 m<sup>2</sup>

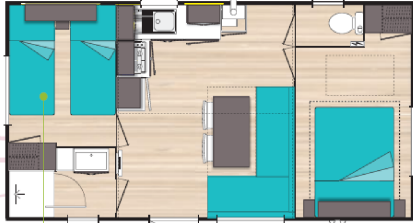

MH OPEHA 26m<sup>2</sup>- 2009 and 2012  
5 persons- 2 bedrooms - 1 bathroom  
1 toilet – paved terrace 9m<sup>2</sup>



COCO SWEET 16m<sup>2</sup> – 2017  
4 persons - 2 bedrooms – terrace 11m<sup>2</sup>  
no water no toilet no sink



MH TAOS F6 40m<sup>2</sup> - 2018, 2020 and 2021  
6 persons – 3 bedrooms - 2 bathrooms  
2 toilets – terrace : 22,5 m<sup>2</sup>

	Coco S	Bora	Ophea	Declik	Taos F4	Taos F6		Coco S	Bora	Ophea	Declik	Taos F4	Taos F6
<b>Bedroom1</b>							toaster		1		1	1	1
bed 140*190 lath work	1	1	1	1			dinner plates	8	6	12	12	12	14
bed 160*200 lath work					1	1	soup plates	4	4	6	6	6	8
canvas under	1	1	1	1	1	1	dessert plate	4	4	6	6	6	8
pillows 50*50	2	2	2	2	2	2	bowls	4	4	6	6	6	6
blanket	2	0	2				cups	4	4	6	6	6	6
comforter		1		1	1	1	mugs		2	5	6	6	6
hanging wardrobe	1	1	1	1	1	1	glasses	6	6	10	10	12	12
coat hangers	4	10	15	15	15	15	wine glasses		4	5	5	6	6
<b>Bedroom2</b>							carafe	1	1	1	1	1	1
bed 80*190 lath work	2		3	3	2	2	egg cups		3		5	5	6
canvas under + pillow	2		3	3	2	2	pieces of tableware *4	5	5	6	6	6	8
blanket	2		3				meat knives		3	6	6	6	6
comforter				3	2	2	kitchen knife+bread + peeler	1	1	1	1	1	1
hanging wardrobe			1			1	can opener corkscrew bottle open	1	1	1	1	1	1
<b>Bedroom3</b>							spatulla	1	1	1	1	1	1
bed 80*190 lath work						2	soup ladle + skimmer	1	1	1	1	1	1
canvas under pillow oomf						2	strainer	1	1	1	1	1	1
hanging wardrobe						1	salad spin + salad cover		1	1	1	1	1
<b>Bathroom 1</b>							coffee pot + filter holder	1	1	1	1	1	1
Shower + sink		1	1	1	1	1	pan	2	2	3	3	3	3
bathroom bin		1	1	1	1	1	frying pan	1	2	2	2	2	2
hair dryer				1	1	1	lid	2	2	2	2	2	2
toilet in the bathroom		1					cooking pot		1	1	1	1	1
separated toilet			1	1	1	1	deep dish		1	1	1	2	2
<b>Bathroom 2</b>							flat dish	1	1	1	1	2	2
Shower + sink					1	1	salad bowl	1	1	1	1	2	2
bathroom bin					1	1	cuttingboard + tablemat	1	1	1	1	1	1
toilet in the bathroom					1	1	butter dish + grater				1	1	1
<b>Kitchen /living room</b>							tray				1	1	1
table	1	1	1	1	1	1	ashtray	1	1	1	1	1	1
chairs		2	2	4	3	4	broom + shovel+ basin	1	1	1	1	1	1
stool+ storage box	4						broom mop + mop bucket	1	1	1	1	1	1
couch		1	1	1	1	1	bucket				1	1	1
pouf chair					1	2	bin	1	1	1	1	1	1
television+ remote contr		1	1	1	1	1	sorting bin		1	1	1	1	1
sink 1 bowl+ drainer		1	1	1	1	1	Mop + mat	1	1	1	1	1	1
4 burner gaz stove		1	1	1	1	1	drying rack + clothes pegs		1	1	1	1	1
induction hob	1						electric convectors	1	1	4	4	3	3
fridge	1						footstool+ low table					1	1
fridge freezer		1	1	1	1	1	outdoor table	1	1	1	1	1	1
microwave oven + lid	1	1	1	1	1	1	outdoor chair	4	3	5	5	4	6
electric coffee machine		1	1	1	1	1	deckchair	2	2	2	2	2	2
electric kettle		1		1	1	1							

NB: The bunk bed is not suitable for a child under 7 years old. Sheets and linen are not provided but we can supply you with disposable sheets or fabrics. We also offer a barbecue for hire. We kindly ask you to clean the Mobile Home before your departure, otherwise we will be obliged to deduct a cleaning fee of 90,00€ from your deposit.

Thank you for your understanding.

**We wish you in advance a very pleasant stay at Camping PRADELONGUE.**